

Accent Panels

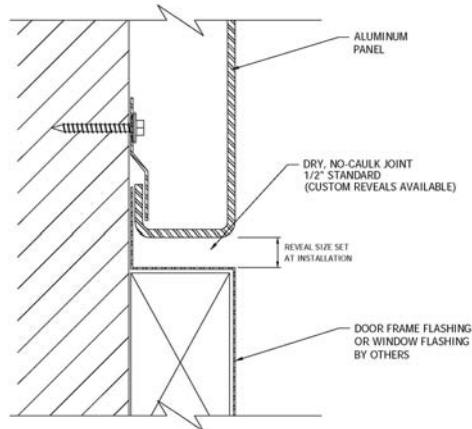

DETAILS DEPICT STANDARD CONDITIONS. CONTACT HICKMAN ENGINEERING FOR CUSTOM DETAILS.

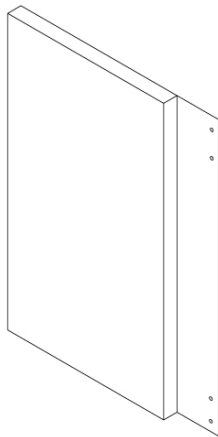
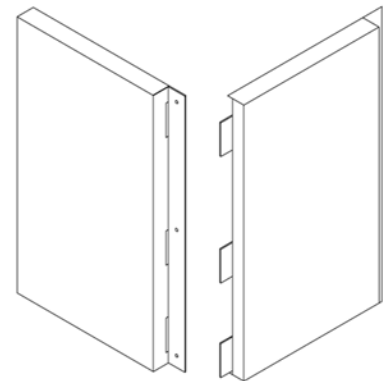

Dry Seal Panel

Dry Seal Joint Detail

Wet Seal Panel

- Hickman Accent Panels are custom plate panels fabricated from heavy gauge .125" aluminum to prevent oil canning.
- Available in a variety of colors and finishes.
- Custom Engineered and sized precisely to existing job conditions.
- Pre-punched holes and supplied fasteners allow for proper attachment and fast installation.
- Matching corners, trims, accessories are available along with true welded radius panels.

W.P. Hickman Company

P.O. Box 15005 • Asheville, NC 28813 • Phone (800) 892-9173 • Fax (828) 274-4031 • www.wph.com

© W.P. Hickman Company February 9, 2010

SPECIFICATIONS

(short form)

Hickman Accent Panels are custom plate panels that are available as a solution in vertical wall or fascia applications where a flat modular aesthetic is designed. The interlocking panels are customized to the dimensions required (MAX MIN) and are available in an array of materials, colors, and finishes. Hickman has two basic panel designs: a wet seal joint where the joint reveal between panels is sealed by the installer with backer rod and caulking and a dry seal joint with an open reveal and no caulking. The panels can be applied in either single or multi-row configurations.

DESCRIPTION

Hickman Accent panels are solid aluminum. The corners are welded and ground smooth. The heavy .125" gauge meet deflection criteria and reduces "oil canning". The aluminum panel offers superior weatherability and can be custom painted to match or contrast with other materials on the project as required. Standard wet seal panel joints are typically ½" wide joints sealed with backer rod and sealant compatible to the panel finish to provide a weather tight system. A dry no-caulk joint style is also available.

INSTALLATION PROCEDURES

Preparation:

Ensure flatness of wall prior to installation. Panels are designed to be fastened to a smooth, flat substrate such as plywood. Application of an approved underlayment prior to panel installation is recommended.

Hickman's engineered, custom panel systems are designed to facilitate fast, easy installation. Product specific installation instructions are furnished by the manufacturer to provide step-by-step guidance through the installation phase. Stainless steel panel screws are supplied with every project and specified based on your specific substrate details. Members of the Hickman Engineering

and Sales staff are available to discuss your upcoming project and will remain available to assist you throughout the procurement and installation phases. Off-the-shelf, standard panels require complex alterations at the time of installation, driving up labor costs and increasing time required to install. Hickman's engineered, custom panel systems are designed around your project's specific details, allowing contractors to install quickly, easily and with little to no on-site fabrication.

FINISHES

Natural mill aluminum
Post-coat Kynar 500® — industry standard two coat colors
Non-standard Kynar 500® — colors requiring multiple coatings or protective clear coats
Anodized aluminum – clear, bronze and black

GUARANTEE

A. Manufacturer's Standard Warranty:

Materials shall be free of defects in material and workmanship for five years after shipment. If, after inspection, the manufacturer agrees that the materials supplied by them are defective, the manufacturer shall at their option repair or replace them.

B. Decorative Finish Warranty (*consult manufacturer*).

TECHNICAL SERVICES

Engineering and shop drawings are available from the factory. Product samples, detail sheets, color chips and color charts are ready for your submittal package. CAD details are available. For personal assistance with questions or submittals, contact your local representative or call the W.P. Hickman Company.



To find your Hickman representative call 1-800-892-9173
or visit our Internet web site at www.wph.com

Represented by: