

INSTALLER NOTE:
ALL CORNERS ARE TO
BE FIELD FABRICATED.

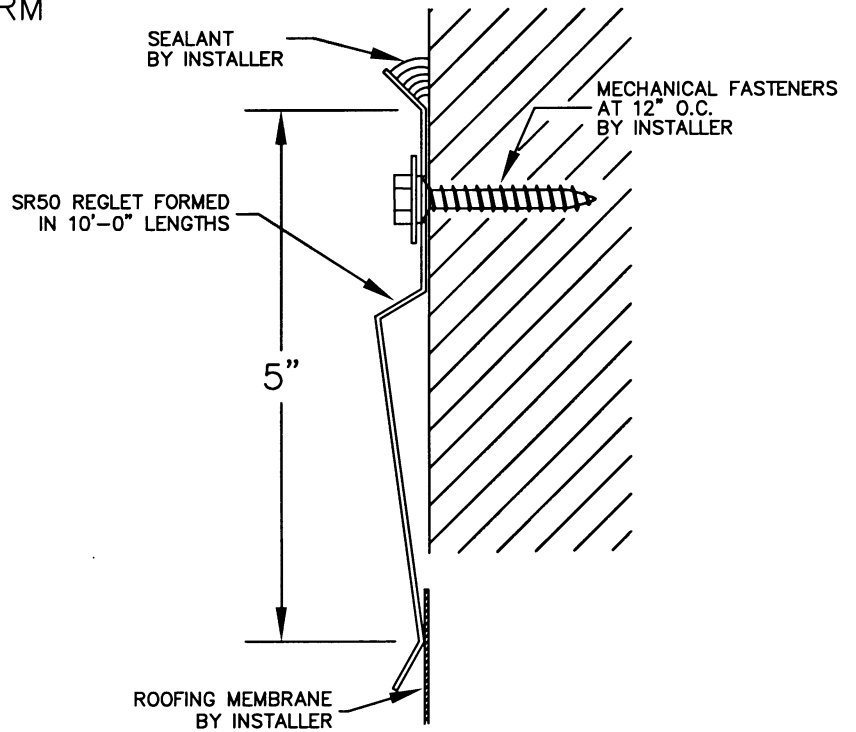

QUANTITY , this detail :

_____ FT. TOTAL PERIMETER

_____ PCS STOCK @ 10'0"

DETAIL	ARCH'L REF.	DESCRIPTION				
MODEL	OPTIONS	SIZE	GAUGE	MATERIAL	FINISH	
<input type="checkbox"/> SR50	<input type="checkbox"/> STD	A = <u>5.0"</u>	<input type="checkbox"/> .050	<input type="checkbox"/> ALUMINUM	<input type="checkbox"/> MILL FINISH	
			<input type="checkbox"/> .063	<input type="checkbox"/> GALV. STEEL	<input type="checkbox"/> KYNAR 500	
			<input type="checkbox"/> 24 Ga.		<input type="checkbox"/> EXOTIC	
					<input type="checkbox"/> CLEAR ANODIZED	
					<input type="checkbox"/> BRONZE ANODIZED	
					<input type="checkbox"/> BLACK ANODIZED	
					<input type="checkbox"/> _____	
COLOR _____						

TRANSMITTAL

REQUEST FOR QUOTATION REQUEST FOR INFORMATION

SUBMIT AS QUOTATION CONFIRMING TELCON

SUBMIT FOR APPROVAL FOR YOUR FILES

BY _____ DATE _____

CUSTOMER APPROVAL :

APPROVED FOR FABRICATION _____

APPROVED WITH CHANGES AUTHORIZED CUSTOMER SIGNATURE _____

DISAPPROVED, RESUBMIT _____

TITLE _____ DATE _____

JOB NAME	JOB #
LOCATION	SHEET OF
CUSTOMER	BY
REPRESENTATIVE	DATE
ARCHITECT	C:\A13\ORDRSPEC\SR50.DWG