

## Reglet and Flashing



### Concealed-Mount CMR 575

The surface mounted wall reglet permits fastener concealment under the continuous snap-on flashing skirt. An attractive and weatherproof counter flashing design.



### Drive-Lock DLR 625

Two-piece counter flashing system with surface mounted reglet / receiver punched for fastening 12" on center. Snap-on metal skirt flashing can be removed for re-roofing or maintenance.



### Surface-Mount SR 50

Standard one-piece design. Sections easily overlap for continuous counter flashing of wall terminated roofing. Fast installation. Pre-punched fastener holes at 12" on center. Custom sizes available on request.



### Snap-On Facing FR 225

Continuous wall retainer bar secures roofing to the wall or blocking with fasteners holes 12" on center. Snap-on metal fascia cover conceals fasteners! Attractive clean lines with your choice of 24 standard Kynar 500® colors.

### W.P. Hickman Company

P.O. Box 15005 • Asheville, NC 28813 • Phone (800) 892-9173 • Fax (828) 274-4031 • [www.wph.com](http://www.wph.com)

© W.P. Hickman Company Revised February, 2005

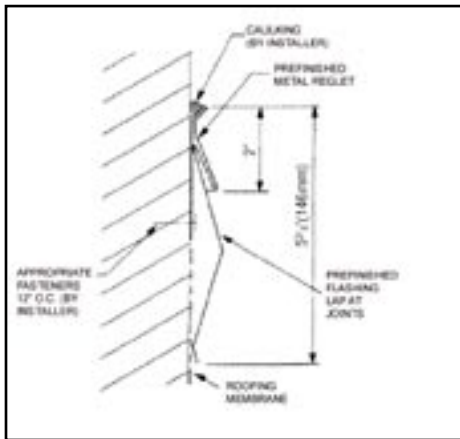

**Concealed-Mount CMR 575**

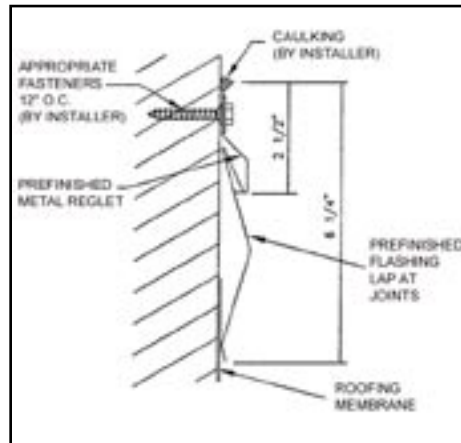

**Drive-Lock DLR 625**

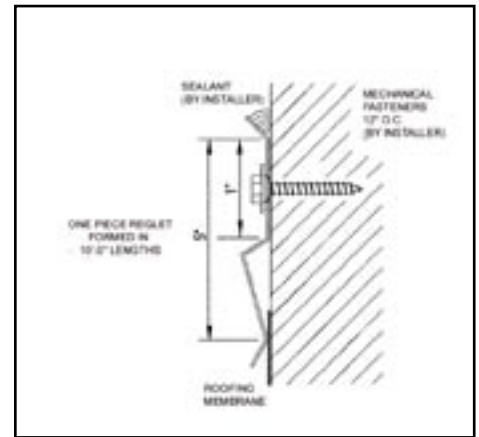

**Surface-Mount SR 50**

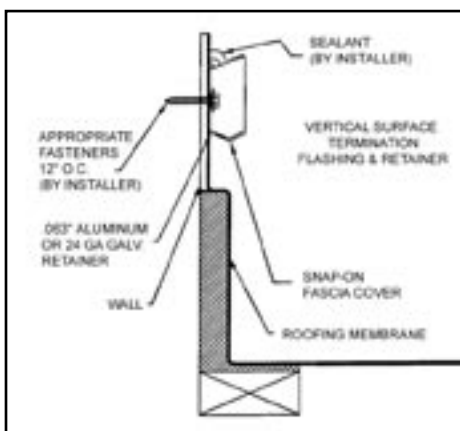

**Snap-On Facing FR 225**

For Vertical Wall Termination

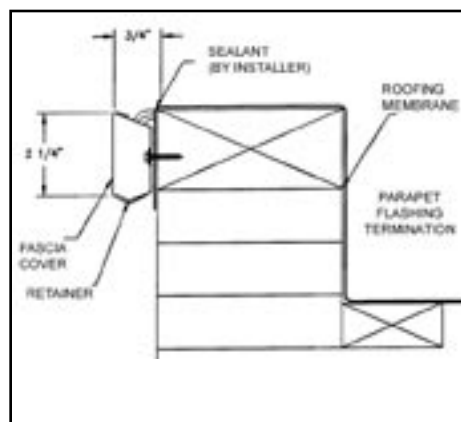

**Snap-On Facing FR 225**

For Parapet Termination

## MATERIAL

Reglets are primarily made from mill aluminum or pre-coat Kynar 500® aluminum sheet. The two piece reglet and flashing details are usually fabricated with an .050” (1.25 mm) reglet head and an .032” (0.80 mm) flashing. Special colors or finishes are available. Finish setups or minimum quantities may be required. Copper or stainless steel reglets by request.

## FINISHES

- Natural mill aluminum
- Pre-coat Kynar 500® - from the manufacturers standard color chart
- Post-coat Kynar 500® - industry standard two coat colors

## GUARANTEE

Manufacturer’s Standard Warranty (*all reglets*): Materials shall be free of defects in material and workmanship for five years after shipment. If, after inspection, the manufacturer agrees that the materials supplied by them are defective, the manufacturer shall at their option repair or replace them. No other warranty expressed or implied.



To find your Hickman representative through Sweet’s Buylines call 1-800-892-1165, enter Hickman’s code #0487, or visit our Internet web site at [www.wph.com](http://www.wph.com)

Represented by: