

## Roof Drainage Systems



**Gutter with Drain Thru Gravel Stop**

Heavy commercial grade water control products

Custom sizes to meet your special requirements.

Hangers and straps designed for snow loads and large water volume.

Matching corners, end caps, elbows, and other accessories are all factory fabricated.

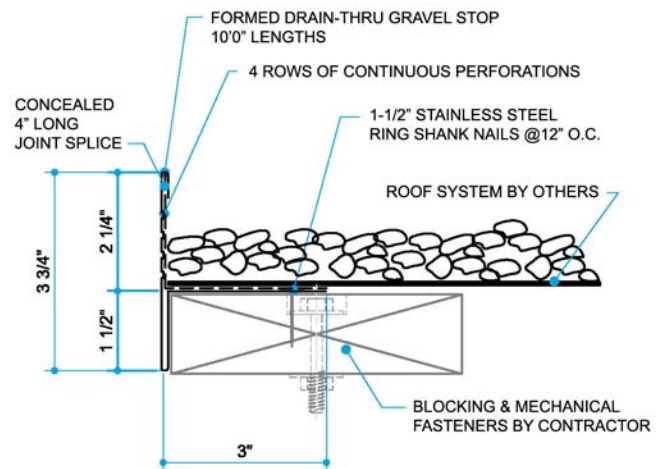
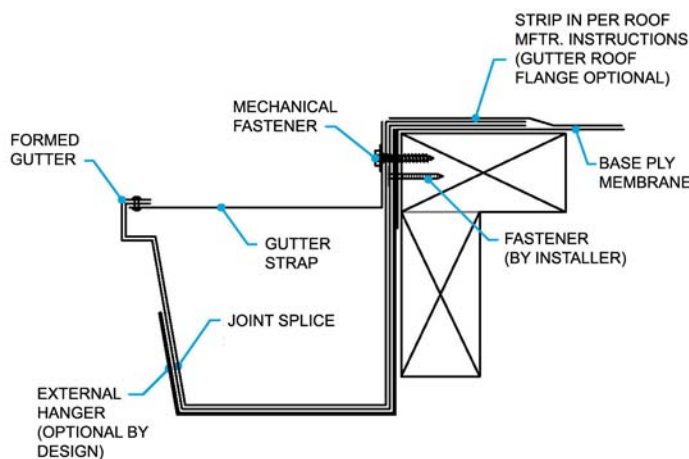

### Custom Formed Gutter

Formed gutters are fabricated from aluminum or Kynar 500® coated galvanized steel. Consult the size chart for common sizes and minimum gauge requirements. Front edge should be a minimum of 1" lower than the back. Support straps and hangers are supplied based upon 30" centers. Install the concealed joint splice with a compatible sealant. Figure an expansion joint every 40-50 feet for long runs.

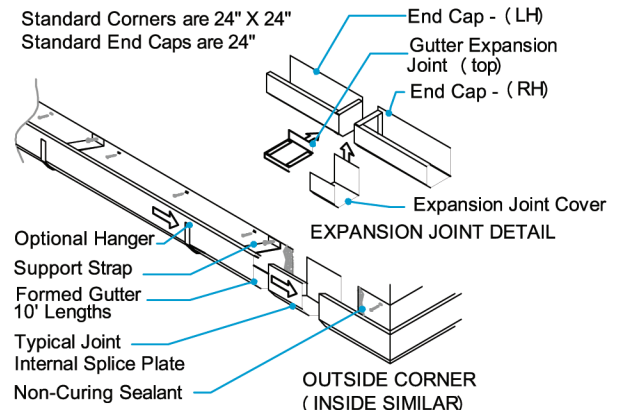

**W.P. Hickman Company**

P.O. Box 15005 • Asheville, NC 28813 • Phone (800) 892-9173 • Fax (828) 274-4031 • www.wph.com

© W.P. Hickman Company Revised March 31, 2009

# ROOF DRAINAGE SYSTEMS

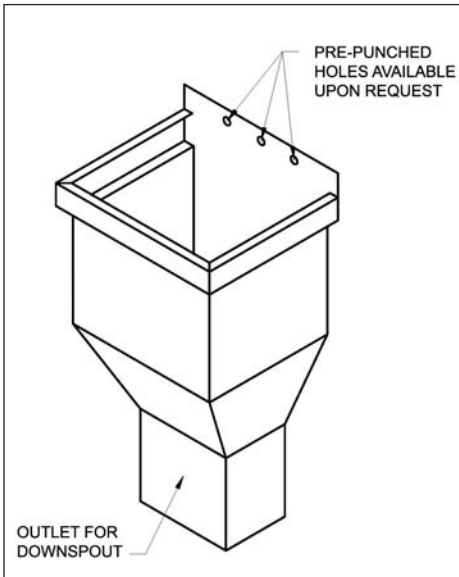

## Conductor Head

Other custom shapes available by request.

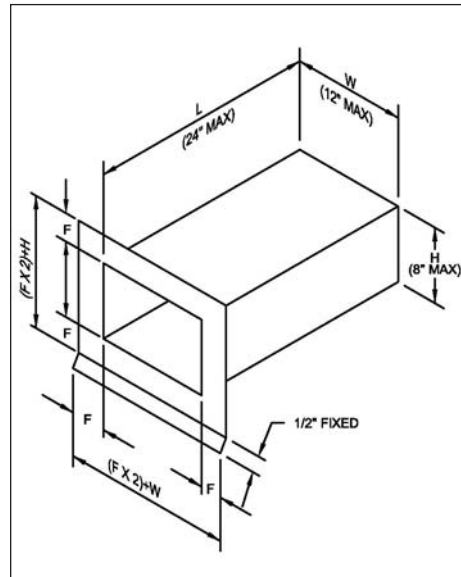

## Through Wall Scupper

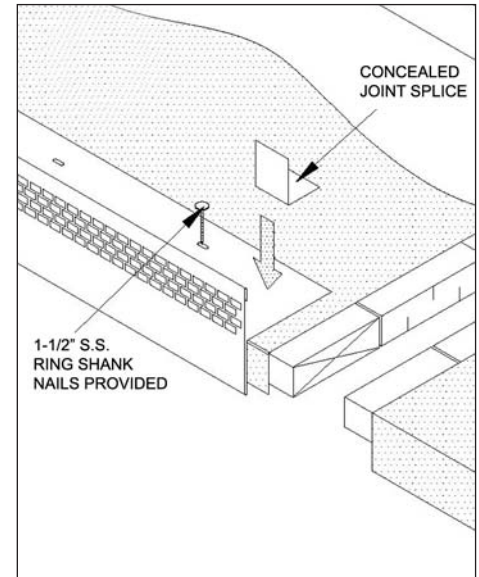

## Drain Thru Gravel Stop

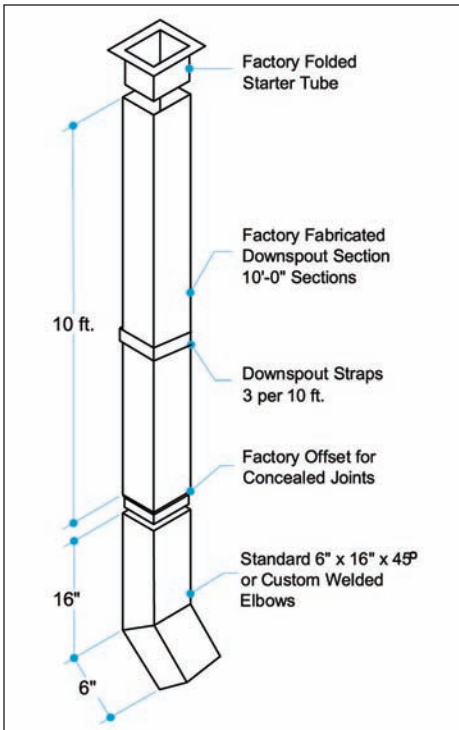

## DRAIN THRU GRAVEL STOP

The Drain Thru Gravel Stop is formed from .032" (0.80 mm), .040" (1.25 mm), and .050" (1.25 mm) aluminum. The sections are 10'-0" (3048 mm) in length with a 4" long concealed splice at each joint. Standard face size is 3 3/4" (95.25 mm). Slotted fastener holes on the deck flange make for easy installation and allow for expansion. Flow rate is calculated to be 267 gallons per hour per foot of gravel stop..

## DOWNSPOUTS

Standard downspouts are available in .050" (1.25 mm) aluminum and 24 ga. Kynar 500® coated galvanized steel. Each section is 10'-0" (3048 mm) in length with an offset at one end for concealed joints. Roof Drain Manufacturers Assn. recommends 1 sq. in. of cross section per 100 sq. ft. of roof area.

## CONDUCTOR HEAD/SCUPPER

The conductor head and/or scupper is factory welded from .050" (1.25 mm) or .063" (1.60 mm) aluminum. Blanks are cut using computer controlled

equipment for precise uniform appearance. Both products are custom sized to meet your needs. Available in mill aluminum or Hickman's standard colors.

## GUARANTEE

Manufacturer's Standard Warranty: Materials shall be free of defects in material and workmanship for five years after shipment. If, after inspection, the manufacturer agrees that the materials supplied by them are defective, the manufacturer shall at their option repair or replace them.

## FINISHES

- Natural mill aluminum
- Pre-coat Kynar 500® - from W.P. Hickman Company's standard color chart
- Post-coat Kynar 500® - industry standard two coat colors
- Non-standard Kynar 500® - colors requiring multiple coatings or protective clear coats
- Anodized aluminum - clear, bronze, and black

Product Number	Width		Depth	
	A (mm)	B	(MM)	
DS34	4"	(102)	3"	(77)
DS44	4"	(102)	4"	(102)
DS45	5"	(127)	4"	(102)
DS46	6"	(153)	4"	(102)
DS66	6"	(153)	6"	(153)

Custom sizes also available



The Leading Edge® since 1945

To find your Hickman representative call 1-800-892-9173 or visit our Internet web site at [www.wph.com](http://www.wph.com)

Represented by: